

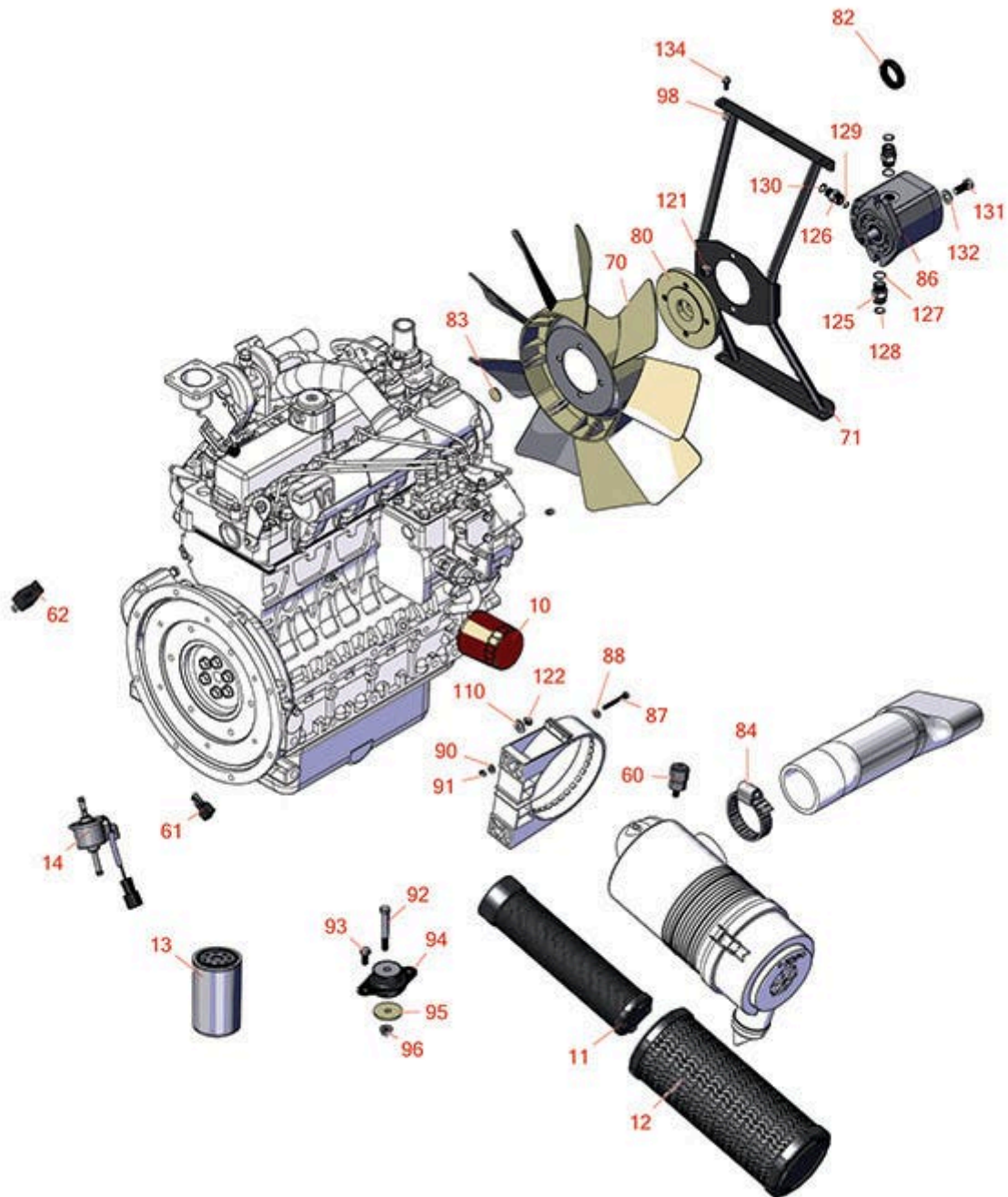

Replaces Toro Groundsmaster 4500-D

Parts

Traction Unit with Yanmar Engine - Model 30881A
Engine

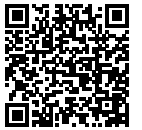

All original equipment manufacturers names and part numbers are used for identification purposes only, and we are in no way implying that our products are original equipment parts. Prices subject to change without notice.



Replaces Toro Groundsmaster 4500-D Parts

*Traction Unit with Yanmar Engine - Model 30881A
Engine*



Item No	R&R Part No.	OEM Part No.	Description	Qty Req	Order Quantity
Filters					
10	R125-7025	125-7025	Baldwin Oil Filter	1	
11	R108-3816	104-4261, 108-3816	Baldwin Air Filter	1	
12	R108-3814	104-4260, 108-3814	Baldwin Air Filter	1	
13	R125-8752	125-8752	Filter - Fuel/Oil Donaldson	1	
14	R121-5613	121-5613, 127-3008, 145-3160	Fuel Pump - Electric	1	
Gauges & Controls					
60	R104-3563	104-3563	Indicator - Service	1	
61	R100-4918	100-4918	Diode	1	
62	R99-7435	99-7435	Relay - 70 Amp	1	
Other Parts Available					
70	R114-3825	114-3825	Fan	1	
71	R120-8935-03	120-8935-03, 137-5594	Bracket - Fan	1	
80	R117-2364	117-2364	Hub-Fan	1	
82	R240-3	240-3	Grommet- Rubber	9	
83	R80-6990	104-1050, 80-6990	Washer - Hardened	4	
84	R2412-125	2412-125	Clamp - Hose - 2 9/16 - 3 1/2	1	
86	R117-4769	114-9762, 117-4769, 137-5571	Motor - Fan Drive	1	

All original equipment manufacturers names and part numbers are used for identification purposes only, and we are in no way implying that our products are original equipment parts. Prices subject to change without notice.



Replaces Toro Groundsmaster 4500-D Parts

*Traction Unit with Yanmar Engine - Model 30881A
Engine*

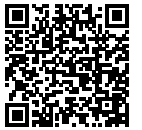

Item No	R&R Part No.	OEM Part No.	Description	Qty Req	Order Quantity
87	R33113-050	33113-050, 60-6650	Screw - Hx HD 6mm	2	
88	R3256-22	24-9-BD, 3-1032, 3256-1, 3256-22, 93-0954, 93-0989	Washer - Flat 1/4 Yellow	2	
90	R6050-103	48-8010, 48-8030	Washer - Flat	2	
91	R33023-00	33023-00, 48-7900, 49-7810	Locknut - ESNA 6mm x 1.0	2	
92	R323-13	01-150-1020, 01-178-0622, 20-54-AD, 20-54-AGD, 323-13, 513366	Bolt - Hex HD 3/8-16 x 2-3/4 GR5	4	
93	R3234-11	3234-11	Bolt - Hex Washer HD	10	
94	R53-9682	53-9682	Motor Mount	4	
95	R63-7400	63-7400	Washer - Rebound	4	
96	R104-8301	104-8301, 104-9301, 109-6658, 133-7570	Locknut - 3/8-16 Nylon Flanged	12	
98	R104-7201	104-7201	Locknut - 1/4-20 ESNA Flanged	6	

All original equipment manufacturers names and part numbers are used for identification purposes only, and we are in no way implying that our products are original equipment parts. Prices subject to change without notice.



Replaces Toro Groundsmaster 4500-D Parts

*Traction Unit with Yanmar Engine - Model 30881A
Engine*



Item No	R&R Part No.	OEM Part No.	Description	Qty Req	Order Quantity
110	R453011	01-166-0100, 01-166-0120, 01-166-0270, 01-166-0500, 01-166-0600, 01-166-0620, 132-4593, 2356-3, 237-12, 24-10-AD, 24-11-AD, 24-11-BD, 24-12-AD, 24-12-BD, 30-9310, 32-8190, 3256-24, 3256-3, 3256-36, 3256-4, 453011, 47-9950, 48-9220, 513458, 7-0052	Washer - Flat 3/8 SAE Y/Zinc	1	
121	R3296-48	119-4039, 32146-7, 3296-34, 3296-48	Locknut - 7/16-14 ESNA	2	
122	R104-8300	104-8300, 104-8300 , 119-4041	Locknut - 5/16-18 Flanged Y/Zinc	2	
125	R340-4	340-4	Hydraulic Fitting - Male Connector	2	
126	R340-2	340-2, 60-1920	Hydraulic Fitting - Striaight	1	
127	R237-79	237-79	O-Ring	2	
128	R237-30	23-6320, 237-30	O-Ring - Seal	2	

All original equipment manufacturers names and part numbers are used for identification purposes only, and we are in no way implying that our products are original equipment parts. Prices subject to change without notice.



Replaces Toro Groundsmaster 4500-D Parts

*Traction Unit with Yanmar Engine - Model 30881A
Engine*

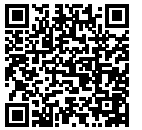

Item No	R&R Part No.	OEM Part No.	Description	Qty Req	Order Quantity
129	R237-22	107-8844, 237-22, 237-78	O-Ring	1	
130	R237-42	237-42, 31-4160	O-Ring	1	
131	R324-5	01-178-0710, 20-64-AGD, 20-67-AGD, 30-8890, 3225-2, 324-5	Bolt - Hex HD	2	
132	R187-0	3256-25, 7-0032	Washer - Flat 7/16 SAE	2	
134	R99-6810	99-6810	Bolt - 1/4-20 x 5/8 Hwh	6	

All original equipment manufacturers names and part numbers are used for identification purposes only, and we are in no way implying that our products are original equipment parts. Prices subject to change without notice.