

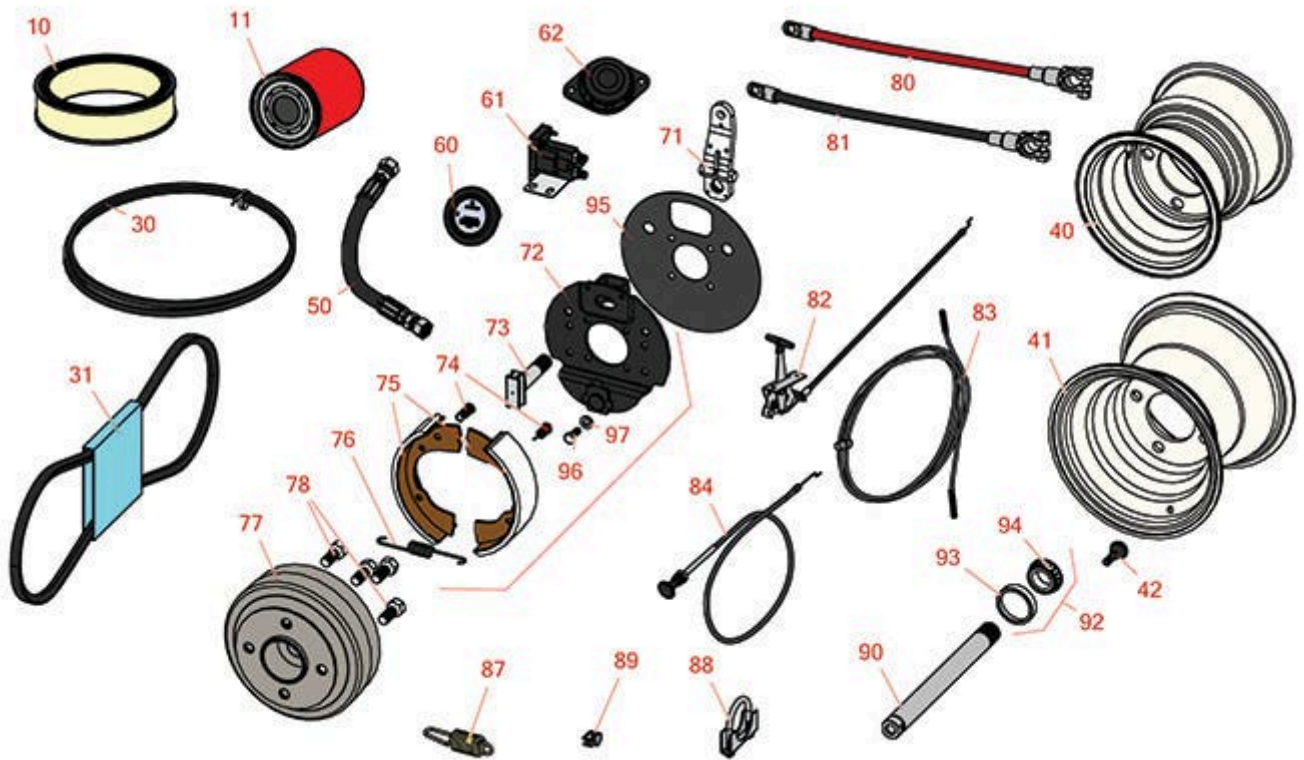

# Replaces Jacobsen Tri-King 1671G Parts

Traction Unit  
Traction Unit



All original equipment manufacturers names and part numbers are used for identification purposes only, and we are in no way implying that our products are original equipment parts. Prices subject to change without notice.



# Replaces Jacobsen Tri-King 1671G Parts

Traction Unit

Traction Unit



Item No	R&R Part No.	OEM Part No.	Description	Qty Req	Order Quantity
<b>Filters</b>					
10	<b>R4708301</b>	4708301	Air Filter	1	
11	<b>R86-3010</b>	108046, 281370, 522972, 549587, 549597, 925023	Baldwin Hydraulic Oil Filter	1	
<b>Belts</b>					
30	<b>R390707</b>	390707	Belt - Drive Set/2	1	
31	<b>R390704</b>	390704	Belt - Mower	3	
40	<b>R121704</b>	121704	Wheel - with Valve Stem	1	
41	<b>R122367</b>	122367	Wheel	2	
<i>Tech Note: Includes Valve Stem:</i>					
42	<b>R232-27</b>	232-27, 360111	Stem - Valve w/ Cap	3	
<b>Hoses</b>					
50	<b>R554751</b>	554751	Hose - Fuel 1/4 in 10 ft	1	
<b>Gauges and Controls</b>					
60	<b>R162723</b>	162723, 358825	Meter - Hour	1	
61	<b>R131905</b>	126070, 131905	Solenoid - Starter	1	
62	<b>R92-6282</b>	554390	Switch - Kill - Seat	1	
<b>Other Parts Available</b>					
70	<b>R501307</b>	501307	Brake Assy	2	

All original equipment manufacturers names and part numbers are used for identification purposes only, and we are in no way implying that our products are original equipment parts. Prices subject to change without notice.



# Replaces Jacobsen Tri-King 1671G Parts

Traction Unit

Traction Unit



Item No	R&R Part No.	OEM Part No.	Description	Qty Req	Order Quantity
<i>Tech Note: Includes: 2ea: R353868 Spring; 1 ea: R130191 Plate, R353869 Spring, R501150 Shoes, R546516 Camshaft &amp; R554526 Lever:</i>					
71	<b>R554526</b>	501151, 554526	Lever - Brake	2	
72	<b>R130191</b>	130191	Plate - Brake Support	2	
73	<b>R546516</b>	546516	Camshaft - Brake	2	
74	<b>R353868</b>	353868	Spring - Shoe Hold Down	4	
75	<b>R501150</b>	501150	Shoe - Brake Set / 2	2	
76	<b>R353869</b>	353869, 555714	Spring - Shoe Return	2	
77	<b>R207461</b>	207461	Drum - Brake	2	
78	<b>R353914</b>	353914	Bolt - Wheel	8	
80	<b>R364162</b>	364162	Cable - Battery Positive	1	
81	<b>R364006</b>	364006	Cable - Battery Negative	1	
82	<b>R338381</b>	338381	Control - Throttle	1	
83	<b>R364226</b>	364226	Cable - Steering	1	
83	<b>R1004293</b>	1004293	Cable - Steering - Heavy Duty	1	
84	<b>R131851</b>	131851	Control - Choke	1	
87	<b>R364164</b>	364164	Spring	1	
88	<b>R348856</b>	348856	Clamp - Muffler - 1-1/2	1	
89	<b>R345666</b>	345666	Clamp	2	
90	<b>R337358</b>	337358	Axle - Steering	1	
92	<b>R500596</b>	500596	Tapered Bearing Set - Cup and Cone	2	

All original equipment manufacturers names and part numbers are used for identification purposes only, and we are in no way implying that our products are original equipment parts. Prices subject to change without notice.



# Replaces Jacobsen Tri-King 1671G Parts

*Traction Unit*

*Traction Unit*



Item No	R&R Part No.	OEM Part No.	Description	Qty Req	Order Quantity
93	<b>R254-72</b>	313456	Cup - Bearing	2	
94	<b>R254-94</b>	313089	Tapered Bearing Cone	2	
95	<b>R390742</b>	390742	Shield	2	
96	<b>R400184</b>	400184, 400194	Screw - 5/16-18 x 3/4 Hex	8	
97	<b>R446136</b>	446134, 446136	Washer - Lock 5/16 Zinc	10	

All original equipment manufacturers names and part numbers are used for identification purposes only, and we are in no way implying that our products are original equipment parts. Prices subject to change without notice.