

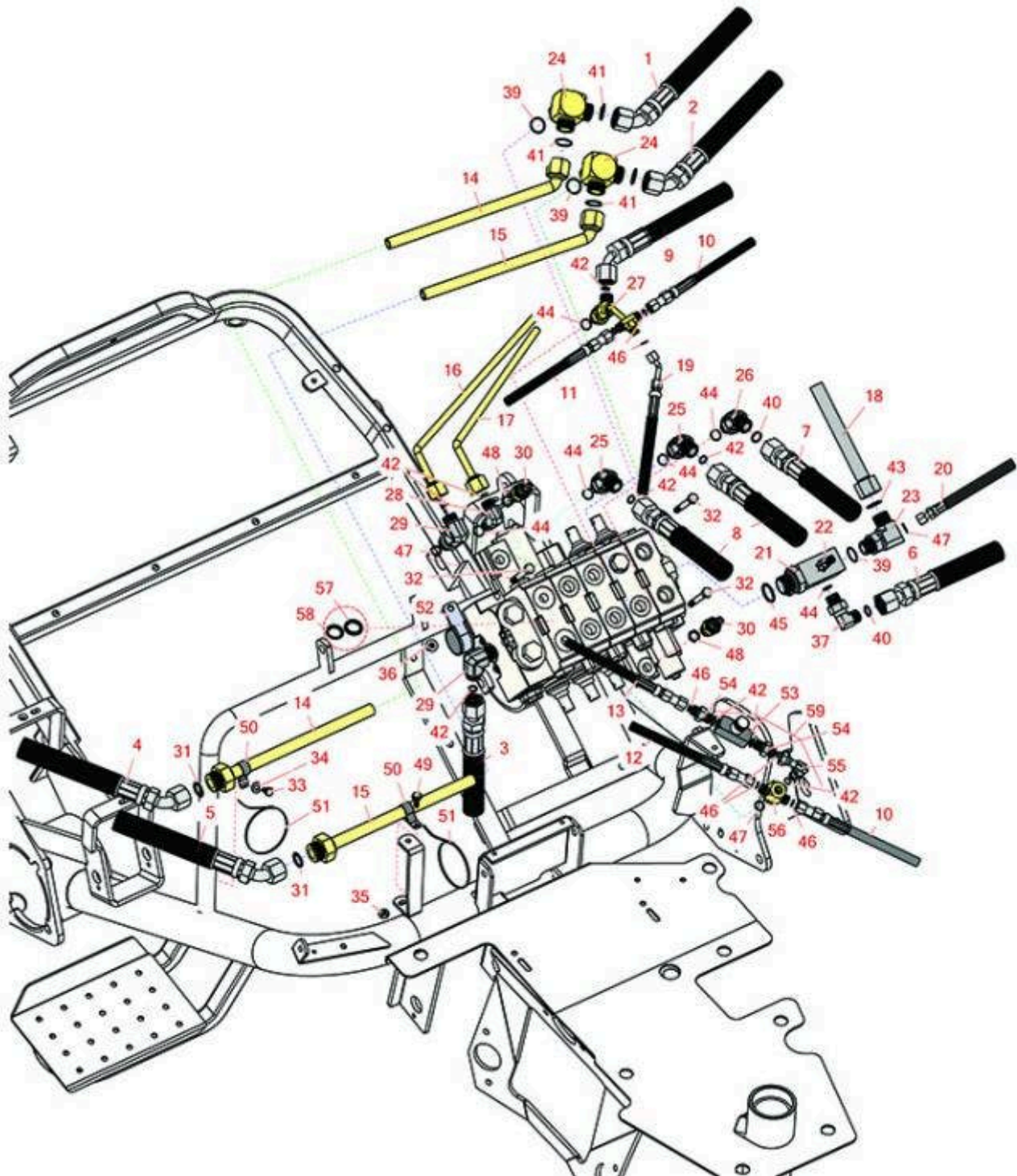

# Replaces Toro Greensmaster 3100 Parts

Traction Unit  
Control Valve



All original equipment manufacturers names and part numbers are used for identification purposes only, and we are in no way implying that our products are original equipment parts. Prices subject to change without notice.



# Replaces Toro Greensmaster 3100 Parts

Traction Unit  
Control Valve



Item No	R&R Part No.	OEM Part No.	Description	Qty Req	Order Quantity
<b>Hoses</b>					
1	R150627		Hydraulic Hose Assy - Drive Motor - RH Upper	1	
2	R150641		Hydraulic Hose Assy - Drive Motor - RH Lower	1	
2	R98-0647	98-0647	Hydraulic Hose Assy - RH Drive Motor	1	
3	R150644		Hydraulic Hose Assy - Valve to Pump	1	
4	R150645		Hydraulic Hose Assy - Drive Motor - LH Upper	1	
4	R98-2153	98-2153	Hydraulic Hose Assy - LH Drive Motor	0	
5	R150642		Hydraulic Hose Assy - Drive Motor - LH Lower	1	
5	R98-0648	98-0648	Hydraulic Hose Assy - LH Drive Motor	1	
6	R150631		Hose - Rear Motor Return	1	
7	R150626		Hydraulic Hose Assy - Valve to Pump	1	
7	R107-9519	107-9519, 98-2151	Hydraulic Hose Assy - Valve to Pump	1	
8	R150620		Hydraulic Hose Assy - Valve to Pump	2	
9	R150633		Hydraulic Hose Assy - Rear Pressure	1	
10	R150640		Hydraulic Hose Assy - RH Lift Cylinder	2	
11	R150632		Hose - Cyl LH Drop Fits	1	
12	R150638		Hydraulic Hose Assy - Front LH Cylinder	1	

All original equipment manufacturers names and part numbers are used for identification purposes only, and we are in no way implying that our products are original equipment parts. Prices subject to change without notice.



# Replaces Toro Greensmaster 3100 Parts

Traction Unit  
Control Valve



Item No	R&R Part No.	OEM Part No.	Description	Qty Req	Order Quantity
13	R150639		Hydraulic Hose Assy - Rear Lift Cylinder	1	
14	R70-7130	70-7130	Line - Tube	1	
15	R83-1200	83-1200	Tube - LH Lower Traction	1	
16	R63-4020	63-4020	Tube - Hyd	1	
17	R63-4030	63-4030	Tube - Hyd	1	
18	R100-6431	100-6431, 63-4040	Tube - Return	1	
19	R150637		Hose - Rear Lift Cyl	0	
20	R150635		Hydraulic Hose Assy - Steering Cylinder	0	

## Other Parts Available

21	R68-5260		Fitting - Valve Manifold - P Steer	1	
22	R340-103	340-103, 340-137	Hydraulic Fitting - 45 Deg	1	
23	R340-16	100-8255, 340-16	Hydraulic Fitting	1	
24	R63-4050	63-4050	Hydraulic Fitting	2	
25	R340-138	340-138	Hydraulic Fitting	2	
26	R340-101	340-101	Hydraulic Fitting	1	
27	R83-1670	83-1670	Fitting Assy - Special	1	
28	R340-18	340-18	Hydraulic Fitting	1	
29	R340-77	340-100, 340-77, 95-7889	Hydraulic Fitting	2	

All original equipment manufacturers names and part numbers are used for identification purposes only, and we are in no way implying that our products are original equipment parts. Prices subject to change without notice.



# Replaces Toro Greensmaster 3100 Parts

Traction Unit  
Control Valve



Item No	R&R Part No.	OEM Part No.	Description	Qty Req	Order Quantity
30	<b>R83-1890</b>	83-1890	Ball Switch - Control Valve	2	
31	<b>R150646</b>		Seal - Flat	2	
32	<b>R322-14</b>	01-150-0830, 01-178-0524, 30-8900, 322-14	Bolt - Hex HD 5/16-18 x 3 GR5	3	
33	<b>R12-3270</b>	12-3270, 30-0700, 32104-17, 9266714, Aug-80	Bolt - Hex Washer 1/4-20 x 1/2	1	
34	<b>R3256-22</b>	24-9-BD, 3-1032, 3256-1, 3256-22, 93-0954, 93-0989	Washer - Flat 1/4 Yellow	1	
35	<b>R301504</b>	2296-42, 301504, 32127-24, 32128-33, 32146-17, 3296-16, 3296-42, 3296-42 , 915661P	Locknut - ESNA 1/4-20	1	
36	<b>R445722</b>	30-8980, 32128-2, 32128-20, 32128-20	Nut - Serrated Washer	3	
37	<b>R150290</b>		Hydraulic Fitting - 90 Deg	1	
39	<b>R237-80</b>	237-80, 327-80	O-Ring	3	
40	<b>R237-30</b>	23-6320, 237-30	O-Ring - Seal	2	

All original equipment manufacturers names and part numbers are used for identification purposes only, and we are in no way implying that our products are original equipment parts. Prices subject to change without notice.



# Replaces Toro Greensmaster 3100 Parts

Traction Unit  
Control Valve



Item No	R&R Part No.	OEM Part No.	Description	Qty Req	Order Quantity
41	<b>R237-65</b>	237-65, 237.65	O-Ring	4	
42	<b>R237-22</b>	107-8844, 237-22, 237-78	O-Ring	5	
43	<b>R237-58</b>	237-58	O-Ring	1	
44	<b>R237-79</b>	237-79	O-Ring	6	
45	<b>R237-81</b>	237-81, 237.81, 327-81	O-Ring	1	
46	<b>R237-21</b>	237-21, 327-21	O-Ring	8	
47	<b>R237-42</b>	237-42, 31-4160	O-Ring	4	
48	<b>R38-0410</b>	38-0410	Nut - Hex - 9/16-18 Thin-SS	2	
49	<b>R3234-4</b>	3234-4	Bolt - Hx Ser Was HD 1/4-20 x 3/4	1	
50	<b>R2412-41</b>	2412-41	Clamp	2	
51	<b>R3M41939</b>		Cable Ties - 8" Bulk Pkg/100	2	
<i>Detail Description: 3M Cable Ties are molded from 6/6 nylon and are available in a variety of sizes and styles, including weather-resistant black for outdoor use.:</i>					
52	<b>R304-61</b>	304-61	Clamp - Hose	1	
53	<b>R150837</b>		Flow Control	1	
54	<b>R340-92</b>	340-92	Hydraulic Fitting - Striaight	2	
55	<b>R150839</b>		Hydraulic Fitting - 90 Deg	1	
56	<b>R150838</b>		Fitting - Special	1	
57	<b>R353-957</b>	353-957	Lip Seal - Control Valve	0	

All original equipment manufacturers names and part numbers are used for identification purposes only, and we are in no way implying that our products are original equipment parts. Prices subject to change without notice.



# Replaces Toro Greensmaster 3100 Parts

Traction Unit  
Control Valve

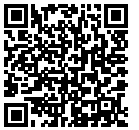

Item No	R&R Part No.	OEM Part No.	Description	Qty Req	Order Quantity
58	<b>R92-2546</b>	92-2546	Wiper Seal - Control Valve	0	
59	<b>R150296</b>		Valve Assy	1	

*Detail Description: Includes: R150299 Fitting, R150839 Fitting, R340-92 Fitting, R150837 Flow Control, R237-42 O-Ring, R237-21 O-Ring & R237-22 O-Ring:*

All original equipment manufacturers names and part numbers are used for identification purposes only, and we are in no way implying that our products are original equipment parts. Prices subject to change without notice.